

nVent LENTON Connect Coupler Transition Chart



ASTM REBAR

Standard nVent LENTON Connect is designed to be used for single-step transitions and in some cases multi-step transitions.

Rebar Size	LC16S2D	LC20S2D	LC22S2D	LC25S2D	LC28S2D	LC32S2D	LC36S2D
	LC16B12D	LC20B12D	LC22B12D	LC25B12D	LC28B12D	LC32B12D	LC36B12D
#4 (12mm)	✓	-	-	-	-	-	-
#5 (16mm)	✓	✓	-	-	-	-	-
#6 (20mm)	-	✓	✓	✓	-	-	-
#7 (22mm)	-	-	✓	✓	-	-	-
#8 (25mm)	-	-	-	✓	✓	-	-
#9 (28mm)	-	-	-	-	✓	✓	-
#10 (32mm)	-	-	-	-	-	✓	✓
#11 (36mm)	-	-	-	-	-	-	✓

✓ Indicates which rebar sizes can be used in each coupler.

The higher-performing nVent LENTON Connect B12-series coupler can be substituted in place of the nVent LENTON Connect S2-series.

Please contact nVent LENTON or visit www.nVent.com/LENTON for specific questions regarding regional availability, approvals or performance requirements.

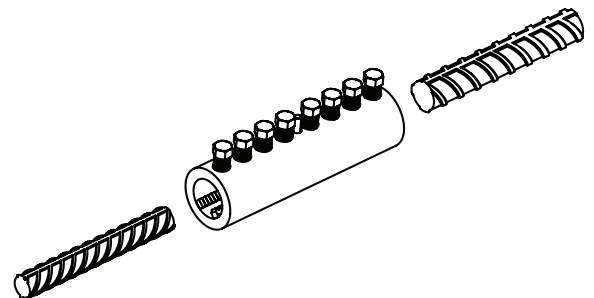

Our powerful portfolio of brands:

CADDY ERICO HOFFMAN RAYCHEM SCHROFF TRACER