

NVENT CADDY EZ RISER

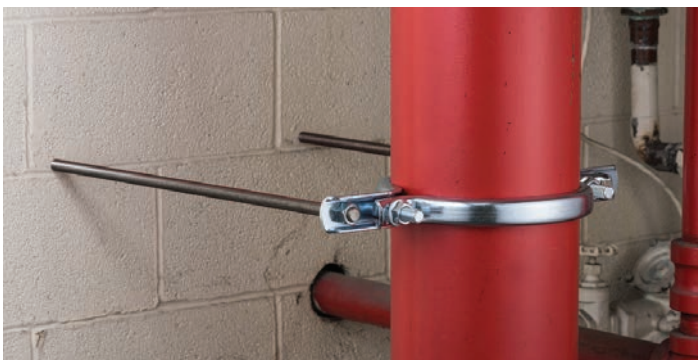

FEATURES

- One-piece hinge design comes out of the box ready to install
- Lack of loose hardware eliminates dropped or lost components, eliminating potential rework and speeding up installation
- Carriage bolts seat into clamp, eliminating the need for multiples tools when tightening**
- Installs up to 60% faster than standard riser clamps and 45% faster than the industry-leading first generation EZ Riser
- Multi-functional clamp can be installed in several approved orientations, simplifying material handling
- Integrated second set of bolt holes allow the assembly to easily adapt from a riser clamp into a stand-off support
- In spaces where full-sized riser clamps do not fit, integrated score marks allow for easy removal of ears
- Retains listing when the ears are removed for close quarters, uniquely making the nVent CADDY EZ Riser capable of a listing in both installations

Material: **Steel** | Finish: **Electrogalvanized**

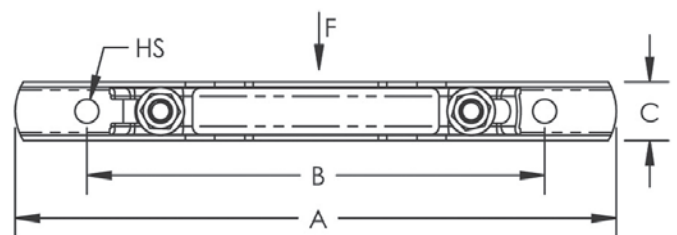
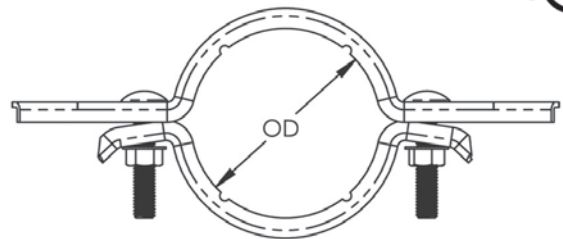

Part Number	Pipe Size	Outer Diameter OD	Hole Size HS	A	B	C	Static Load F	Certifications
EZR0050	1/2"	0.840"	0.39"	8 1/2"	5 1/8"	7/8"	255 lb	cULus
EZR0075	3/4"	1.050"	0.39"	9"	5 3/8"	7/8"	255 lb	cULus
EZR0100	1"	1.315"	0.39"	9"	5 5/8"	7/8"	255 lb	cULus
EZR0125	1 1/4"	1.660"	0.39"	9 1/2"	6"	7/8"	255 lb	cULus
EZR0150	1 1/2"	1.900"	0.39"	9 7/8"	6 1/4"	7/8"	255 lb	cULus
EZR0200	2"	2.375"	0.39"	10 1/4"	7"	1"	255 lb	cULus
EZR0250	2 1/2"	2.875"	0.39"	11"	7 1/2"	1"	390 lb	cULus
EZR0300	3"	3.500"	0.39"	11 3/4"	8 1/8"	1"	530 lb	cULus
EZR0350	3 1/2"	4.000"	0.52"	12 5/8"	9 3/8"	1 1/4"	670 lb	cULus
EZR0400	4"	4.500"	0.52"	13"	10"	1 1/4"	810 lb	cULus
EZR0500	5"	5.563"	0.52"	14 1/2"	11 3/4"	1 1/2"	1,160 lb	cULus
EZR0600	6"	6.625"	0.52"	16"	12 3/4"	1 1/2"	1,570 lb	cULus

Clamp is fitted for steel pipe and should be installed below a coupling or shear lug, with bolts torqued to recommended value.



Our powerful portfolio of brands:

CADDY ERICO HOFFMAN RAYCHEM SCHROFF TRACER