

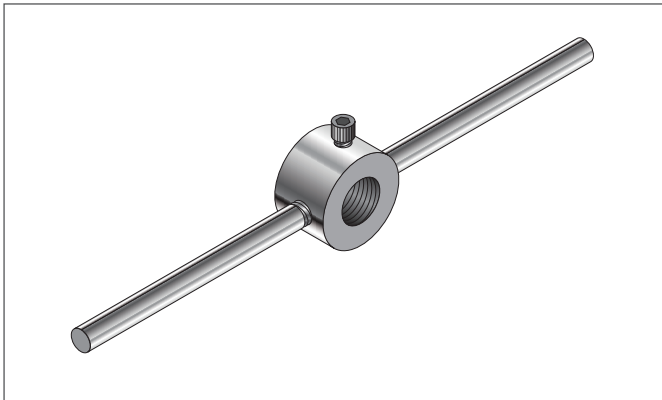

PYROTENAX

Pyropotter Tool

User Instructions for Tool Used to Thread Brass Pots onto Copper Sheathed Mineral Insulated Wiring Cables



DESCRIPTION

The nVent PYROTENAX Pyropotter Tool simplifies installation of the pot, allowing it to be installed more quickly, accurately and securely than by any other means.

TOOLS REQUIRED

- 3/16 in Allen key for 1/2 in and 3/4 in Pyropotter Tools
- 5/16 in Allen key for 1 in and 1-1/4 in Pyropotter Tools

KIT CONTENTS

Item	Qty	Description
A	1	Pyropotter Tool
B	1	This instruction sheet

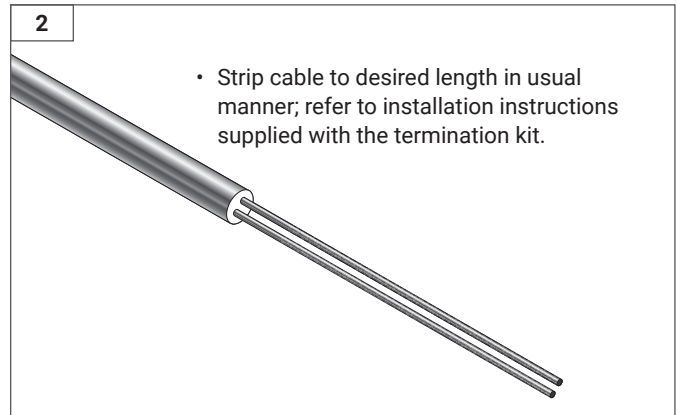
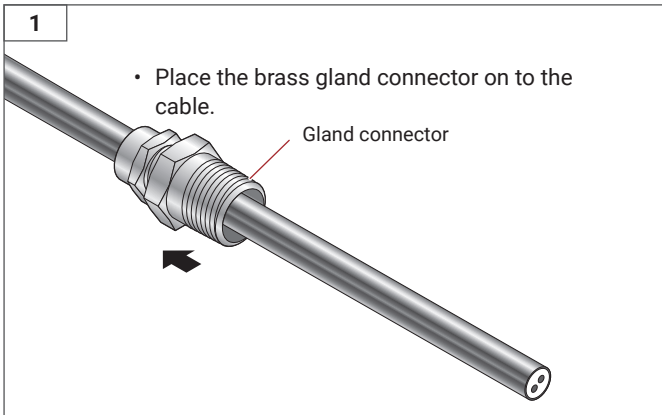

3

- Ensure you have the correct size Pyropotter Tool; the hole in the non-threaded end of the tool should be slightly larger than the brass pot.
- Place the pot, knurled end first, into the non-threaded end of the Pyropotter Tool with the larger hole of the pot facing outwards and protruding past the end of the tool. The length of the pot protruding past the end of the Pyropotter Tool varies depending on the Pyropotter Tool size as shown below.

Pyropotter Tool Size	Length of pot protruding
1/2 in	1/16 in (1.5 mm)
3/4 in	3/8 in (9.5 mm)
1 in	3/8 in (9.5 mm)
1-1/4 in	5/8 in (16 mm)

- Next, tighten the Allen screw on to the pot. Use a 3/16 in Allen key for the 1/2 in and 3/4 in Pyropotter Tool and a 5/16 in Allen key for the 1 in and 1-1/4 in Pyropotter Tool.

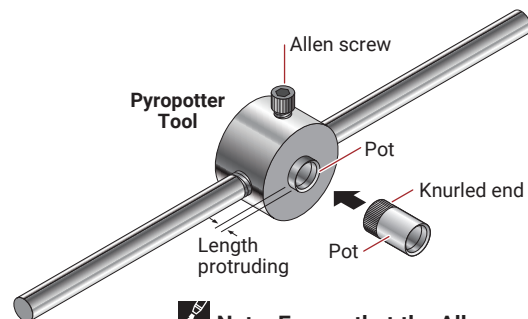

Note: Ensure that the Allen screw is tightened onto the knurled end of the pot.

4

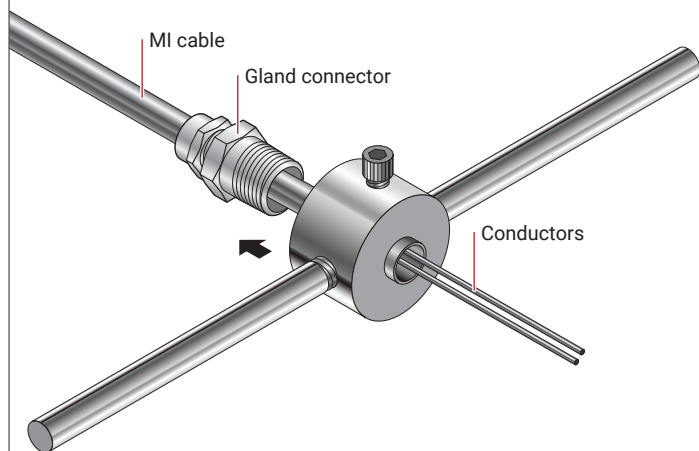

- Slide the Pyropotter Tool/pot assembly over the exposed conductors of the cable, threaded end of Pyropotter Tool first, until it stops at the face of the cable.
- Screw the gland connector (already on the cable) all the way into the threaded end of the Pyropotter Tool - finger tight is sufficient.

5

- To install the pot on to the cable, turn the Pyropotter Tool in a clockwise direction while simultaneously applying light pressure. This will engage the internal screw thread of the pot onto the sheath of the MI cable.

- Continue rotating the assembly until the end of the copper sheath projects 1/8 inch (3 mm) inside the pot.

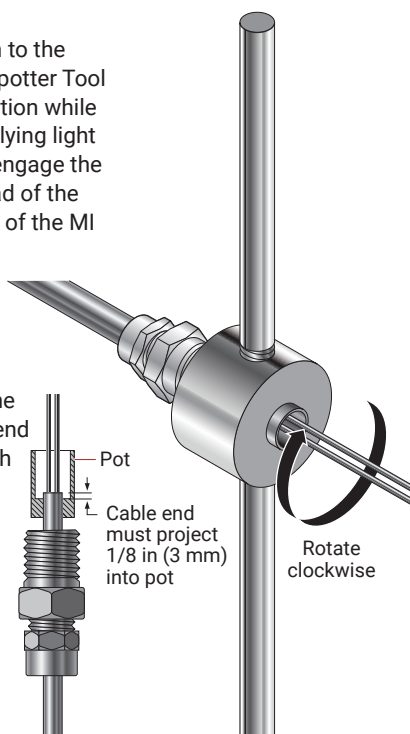

6

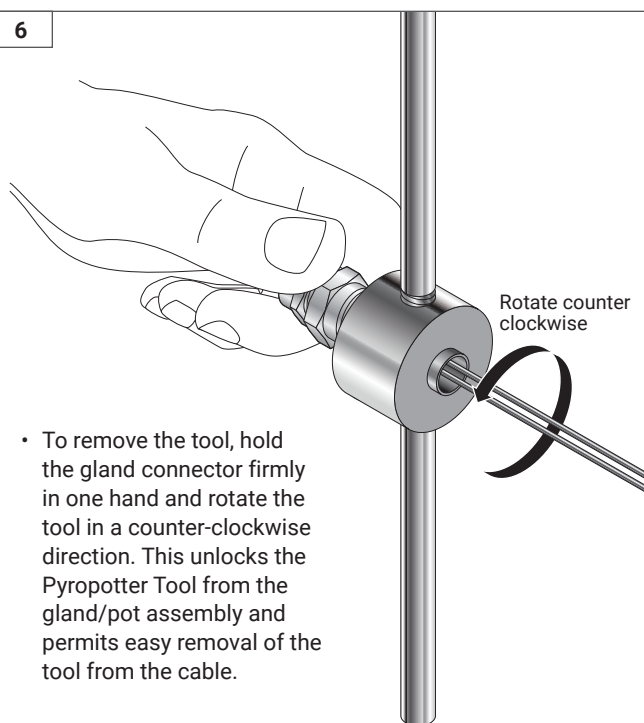

- To remove the tool, hold the gland connector firmly in one hand and rotate the tool in a counter-clockwise direction. This unlocks the Pyropotter Tool from the gland/pot assembly and permits easy removal of the tool from the cable.

North America

Tel +1.800.545.6258
Fax +1.800.527.5703
thermal.info@nvent.com

Europe, Middle East, Africa

Tel +32.16.213.511
Fax +32.16.213.604
thermal.info@nvent.com

Asia Pacific

Tel +86.21.2412.1688
Fax +86.21.5426.3167
cn.thermal.info@nvent.com

Latin America

Tel +1.713.868.4800
Fax +1.713.868.2333
thermal.info@nvent.com



nVent.com

©2019 nVent. All nVent marks and logos are owned or licensed by nVent Services GmbH or its affiliates. All other trademarks are the property of their respective owners. nVent reserves the right to change specifications without notice.

Pyrotex-IM-H59038-Pyropotter-EN-1901