

STRAP CABLE/POINT TO PIPE SUPPORT



CERTIFICATIONS



FEATURES

Attaches air terminals or conductors to pipe or handrails

SPECIFICATIONS

Finish Tinned

Catalog Number	Material	Diameter(Ø)	Outer Diameter(OD)	Depth(D)	Unit Weight
LPA671	Aluminum	0.400" – 0.625"	1.900" – 2.400"	1 1/4"	0.105 lb
LPA672	Aluminum	0.400" – 0.625"	2 3/8" – 2 7/8"	1 1/4"	0.260 lb
LPC671	Copper	0.400" – 0.625"	1.900" – 2.400"	1 1/4"	0.200 lb
LPC672	Copper	0.400" – 0.625"	2 3/8" – 2 7/8"	1 1/4"	0.260 lb
LPA673	Aluminum	0.400" – 0.625"	3 1/2" – 4"	1 1/4"	0.370 lb
LPC673	Copper	0.400" – 0.625"	3 1/2" – 4"	1 1/4"	0.370 lb
LPA674	Aluminum	0.400" – 0.625"	4 1/2" – 5"	1 1/4"	0.495 lb
LPC674	Copper	0.400" – 0.625"	4 1/2" – 5"	1 1/4"	0.495 lb

DIAGRAMS

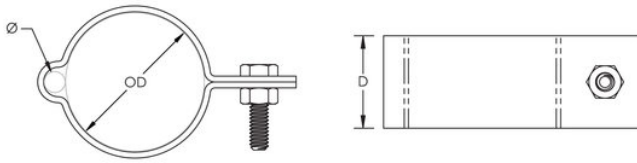

WARNING

nVent products shall be installed and used only as indicated in nVent's product instruction sheets and training materials. Instruction sheets are available at www.nvent.com and from your nVent customer service representative. Improper installation, misuse, misapplication or other failure to completely follow nVent's instructions and warnings may cause product malfunction, property damage, serious bodily injury and death and/or void your warranty.

⚠ WARNING: This product can expose you to chemicals including lead, which is known to the State of California to cause cancer and birth defects or other reproductive harm. For more information go to www.P65Warnings.ca.gov.

North America

+1.800.753.9221

Option 1 – Customer Care

Option 2 – Technical Support

Europe

Netherlands:

+31 800-0200135

France:

+33 800 901 793

Europe

Germany:

800 1890272

Other Countries:

+31 13 5835404

APAC

Shanghai:

+ 86 21 2412 1618/19

Sydney:

+61 2 9751 8500



Our powerful portfolio of brands:

nVent.com **CADDY ERICO HOFFMAN RAYCHEM SCHROFF TRACER**

© 2022 nVent. All nVent marks and logos are owned or licensed by nVent Services GmbH or its affiliates. All other trademarks are the property of their respective owners.

nVent reserves the right to change specifications without notice.