

# SOLID COPPER GROUND ROD, POINTED



## FEATURES

Solid copper ground rods made of high conductive hard drawn bare copper

## SPECIFICATIONS

**Material** Copper  
**Tensile Strength** 42,000 psi Min

Catalog Number	Ground Rod Diameter, Nominal	Ground Rod Diameter, Actual(Ø)	Length(L)	Unit Weight
LPC700	1/2"	0.500"	8'	6.100 lb
LPC702	1/2"	0.500"	10'	7.600 lb
LPC704	5/8"	0.625"	8'	9.500 lb
LPC706	5/8"	0.625"	10'	11.800 lb
LPC711	3/4"	0.750"	10'	17 lb

## ADDITIONAL PRODUCT DETAILS

Due to the inherent softness of the copper material, special consideration should be given when driving this product into the soil.

## DIAGRAMS

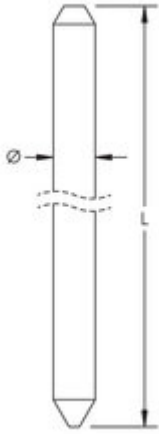

## WARNING

nVent products shall be installed and used only as indicated in nVent's product instruction sheets and training materials. Instruction sheets are available at [www.nvent.com](http://www.nvent.com) and from your nVent customer service representative. Improper installation, misuse, misapplication or other failure to completely follow nVent's instructions and warnings may cause product malfunction, property damage, serious bodily injury and death and/or void your warranty.

### North America

+1.800.753.9221

Option 1 – Customer Care

Option 2 – Technical Support

### Europe

Netherlands:

+31 800-0200135

France:

+33 800 901 793

### Europe

Germany:

800 1890272

Other Countries:

+31 13 5835404

### APAC

Shanghai:

+ 86 21 2412 1618/19

Sydney:

+61 2 9751 8500



Our powerful portfolio of brands:

**nVent.com** CADDY ERICO HOFFMAN RAYCHEM SCHROFF TRACER

© 2022 nVent. All nVent marks and logos are owned or licensed by nVent Services GmbH or its affiliates. All other trademarks are the property of their respective owners.

nVent reserves the right to change specifications without notice.