

NOTCHED CAST U-BOLT PIPE CLAMP

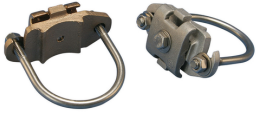

CERTIFICATIONS



FEATURES

Clamp for bonding of handrails and pipes to the lightning protection system

Notched hole makes assembly easy and eliminates loose hardware

Listed to UL® 96

SPECIFICATIONS

Conductor Size, UL Class 1 - Class 2 (4/0 Max)

Catalog Number	Material	Finish	Outer Diameter(OD)	Depth(D)	Height(H)	Width(W)	Unit Weight
LPA571	Aluminum	Bare	2" – 2 1/2"	1.960"	3 1/2"	3.630"	0.400 lb
LPC571	Brass	Bare	2" – 2 1/2"	1.960"	3 1/2"	3.630"	0.835 lb
LPC571L	Brass	Tinned	2" – 2 1/2"	1.960"	3 1/2"	3.630"	0.835 lb

DIAGRAMS

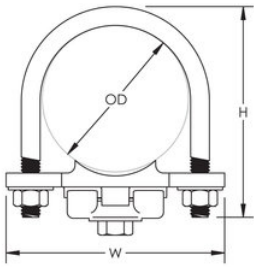

WARNING

nVent products shall be installed and used only as indicated in nVent's product instruction sheets and training materials. Instruction sheets are available at www.nvent.com and from your nVent customer service representative. Improper installation, misuse, misapplication or other failure to completely follow nVent's instructions and warnings may cause product malfunction, property damage, serious bodily injury and death and/or void your warranty.

North America

+1.800.753.9221
 Option 1 – Customer Care
 Option 2 – Technical Support

Europe

Netherlands:
 +31 800-0200135
 France:
 +33 800 901 793

Europe

Germany:
 800 1890272
 Other Countries:
 +31 13 5835404

APAC

Shanghai:
 + 86 21 2412 1618/19
 Sydney:
 +61 2 9751 8500



Our powerful portfolio of brands:
nVent.com CADDY ERICO HOFFMAN RAYCHEM SCHROFF TRACER