



## SNAP CLOSE CONDUIT CLAMP WITH NAIL BRACKET, 1/2", 3/4" EMT, 1/2", 3/4" RIGID

### CATALOG NUMBER

**CNB812M**



### CERTIFICATIONS



### FEATURES

Used to attach conduit to wood, steel or concrete

Eliminates need for offset bending conduit

Works with power tools, screw guns or nails

May be attached after positioning conduit

### PRODUCT ATTRIBUTES

Material: Spring Steel

Finish: nVent CADDY Armour

EMT Conduit Size: 1/2";3/4"

Rigid Conduit Size: 1/2";3/4"

Outer Diameter (OD): 0.710" - 1.18"

Hole Size (HS): 3/16"

## ADDITIONAL PRODUCT DETAILS

---

No load rating, for positioning only.

## DIAGRAMS

---

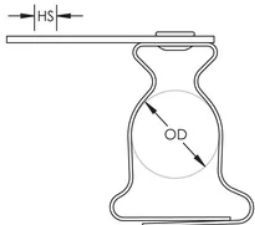

## WARNING

---

nVent products shall be installed and used only as indicated in nVent's product instruction sheets and training materials. Instruction sheets are available at [www.nvent.com](http://www.nvent.com) and from your nVent customer service representative. Improper installation, misuse, misapplication or other failure to completely follow nVent's instructions and warnings may cause product malfunction, property damage, serious bodily injury and death and/or void your warranty.

### North America

+1.800.753.9221

Option 1 – Customer Care

Option 2 – Technical Support

### Europe

Netherlands:

+31 800-0200135

France:

+33 800 901 793

### Europe

Germany:

800 1890272

Other Countries:

+31 13 5835404

### APAC

Shanghai:

+ 86 21 2412 1618/19

Sydney:

+61 2 9751 8500



Our powerful portfolio of brands:  
**nVent.com CADDY ERICO HOFFMAN RAYCHEM SCHROFF**  
**TRACER**