



RAYCHEM

OS-C25-100-W

Connection kit to connect nVent RAYCHEM heating cables with wall mounted junction boxes ht-01; ht-02; a-101010, and a-151010 , ht-10, ht-20, ht-30 ht-40 and ht-60

Installation instructions

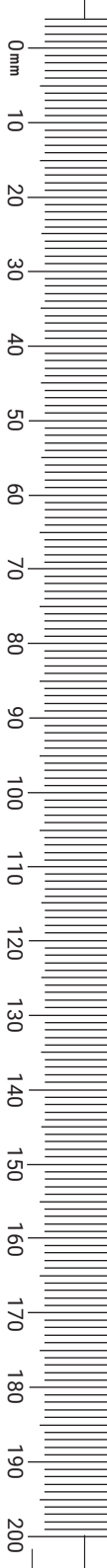

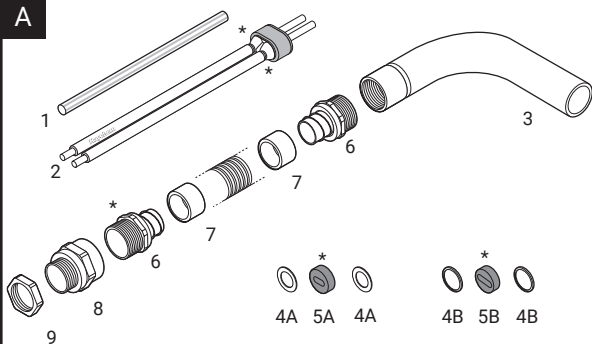
A

*: OS-C25-W contains 2 pieces of single slot grommets and one time pieces 1, 2 and 3 each;

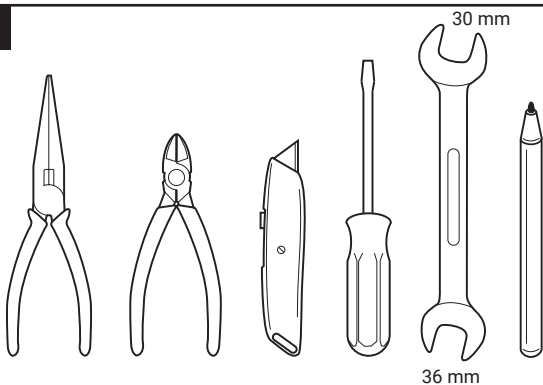
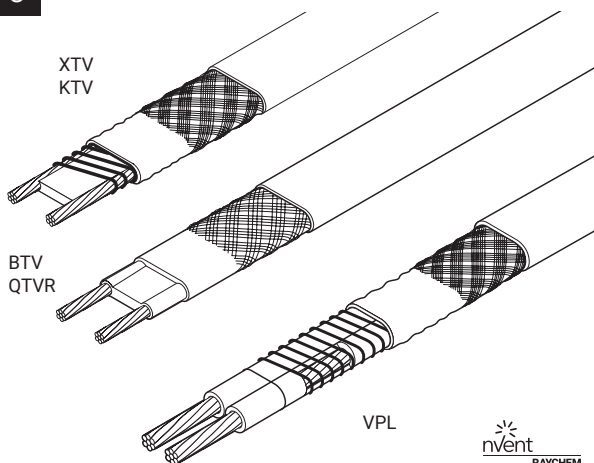
B**C**

OS-C25-100-W

Installation instruction for connection kit nVent RAYCHEM OS-C25-100-W. For use with all nVent RAYCHEM BTV-, QTVR-, XTV-, KTV- and VPL-heating cables.

⚠ WARNING: To prevent electrical shock, short circuit or arcing, this product must be installed correctly and water ingress must be avoided before and during the installation.

Before installing this product, read the installation instructions completely.

Note: Locate junction boxes for easy access but not where they will be exposed to mechanical abuse.

Fix lids in place when access is not required.

Leave loop in heating cable at the connections for future possible repair.

Additional heating cable should be looped around the pipe.

Do not strain heating cable as it exits or enters the junction box or transition unit.

1	
	<div>Grommet slot 5x11mm</div> <div>Grommet slot 5x15mm</div>
3BTV2-CT	✓
5BTV2-CT	
8BTV2-CT	
10BTV2-CT	✓
10QTVR2-CT	✓
15QTVR2-CT	
20QTVR2-CT	✓
4XTV2-CT-T3	
8XTV2-CT-T3	
12XTV2-CT-T3	✓
15XTV2-CT-T3	
20XTV2-CT-T2	
5KTV2-CT	
8KTV2-CT	
15KTV2-CT	✓
20KTV2-CT	
5VPL*-CT	
10VPL*-CT	✓
15VPL*-CT	
20VPL*-CT	

Select grommets / washers according to heating cable by using this table *: 1, 2 or 4

2

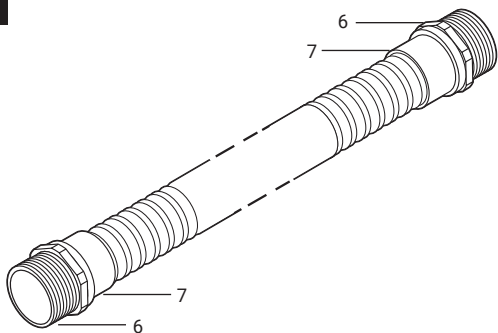

Conduit supplied separately. ⚠ Remove sharp edges.
 Fix conduit seal (7) and conduit adaptor (6) to both ends.
 ⚠ Check that no sharp edges are left exposed.

3

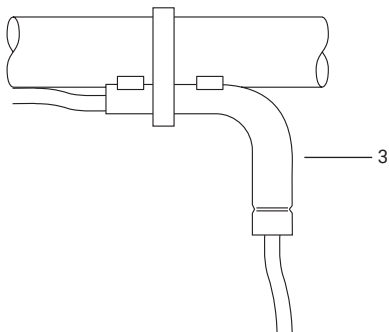

Slide transition unit (3) onto heating cable. Fix to pipe with pipe strap.

4

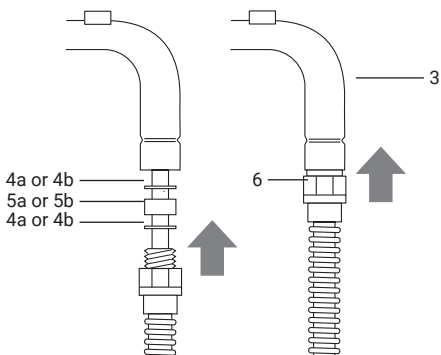

Slide washer (4a or 4b), grommet (5a or 5b) and washer (4a or 4b) on to the heating cable.
 Slide conduit onto heating cable. Screw conduit adaptor (6) into transition unit (3) and compress grommet.

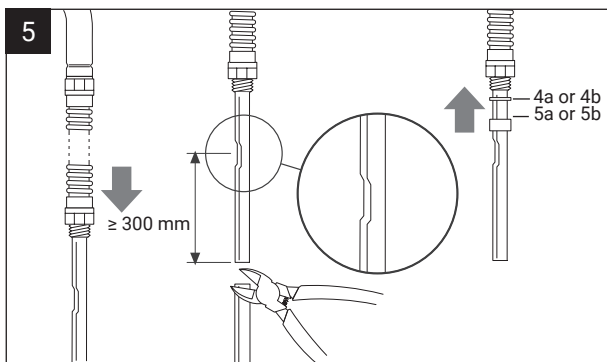

Stretch conduit to its full length. Cut heating cable. Slide washer (4a or 4b) and grommet (5a or 5b) onto heating cable. For VPL only: do not cut cable < 300 mm from a node.

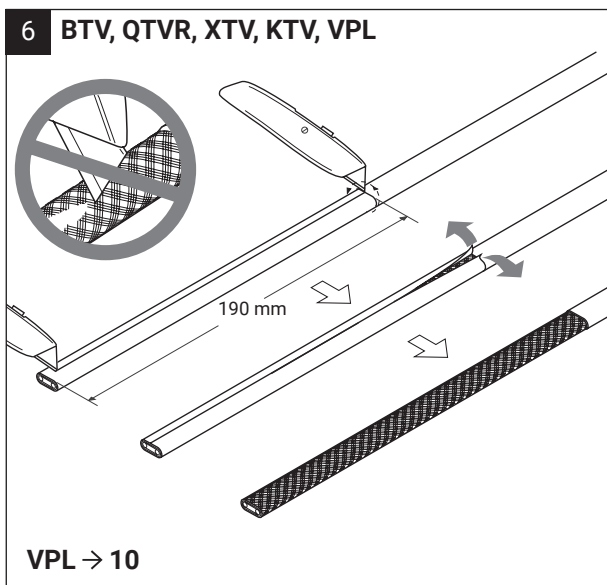

7 BTV, QTVR, XTV, KTV

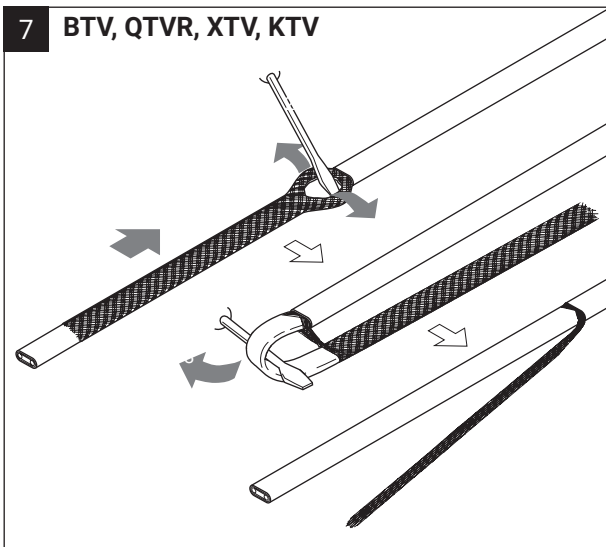

8 BTV, QTVR, XTV, KTV

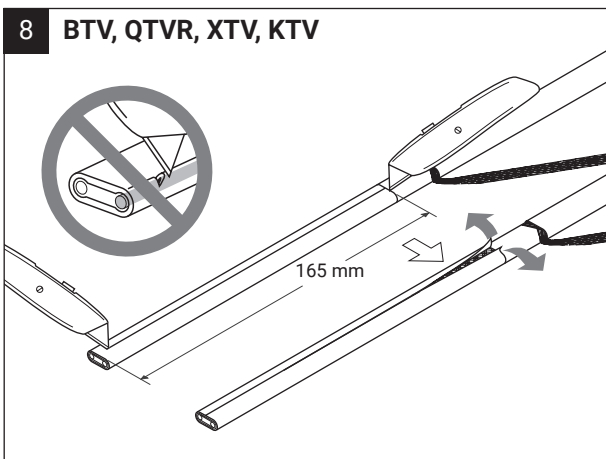

9 BTV, QTVR, XTV, KTV

BTV & QTVR

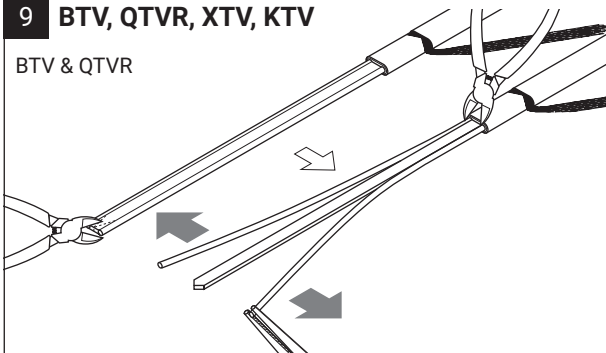

KTV & XTV

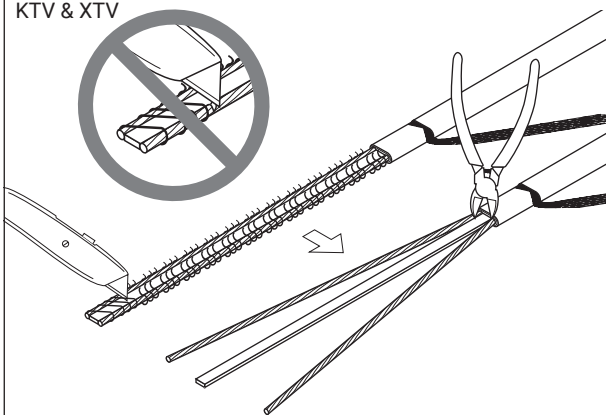

BTV, QTVR, XTV, KTV → 16

10 VPL

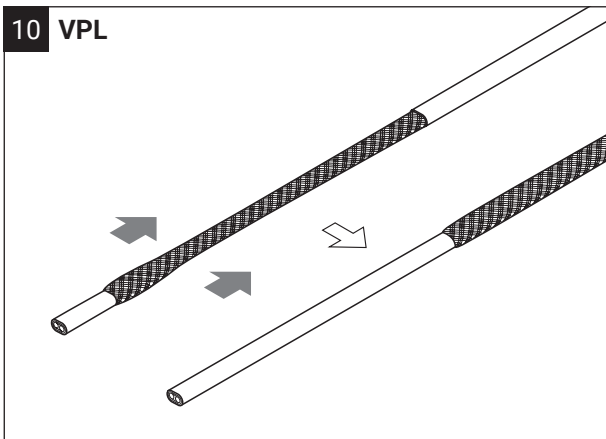

11 VPL

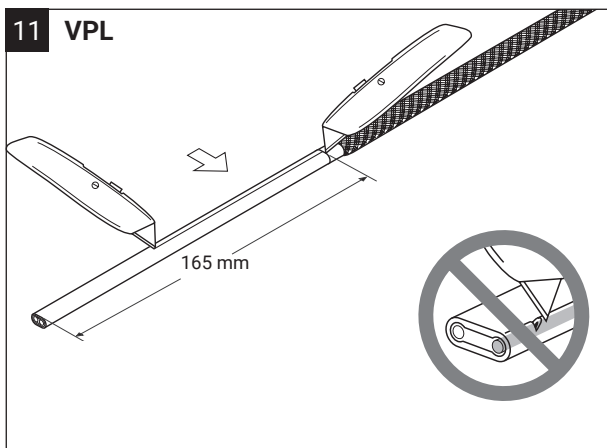

12 VPL

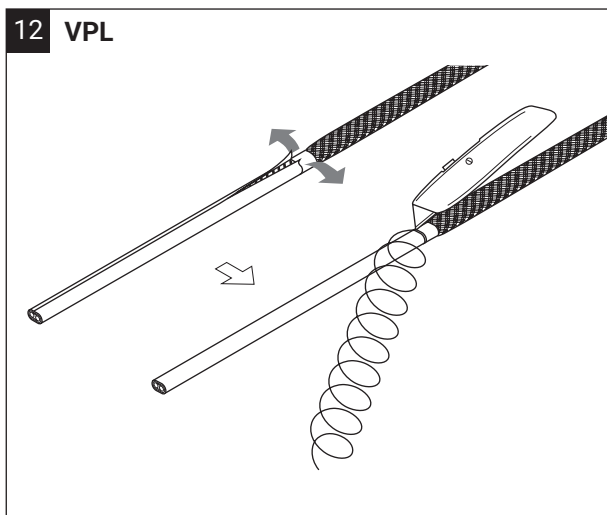

13 VPL

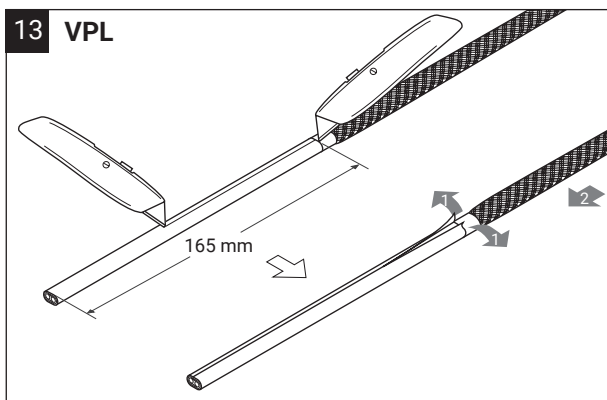

14 VPL

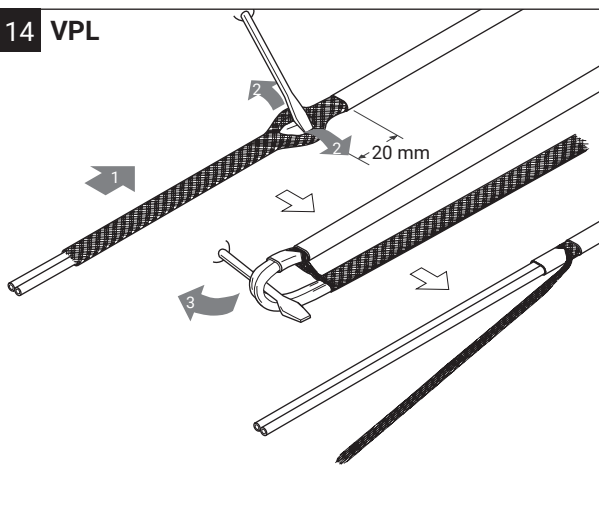

15 VPL

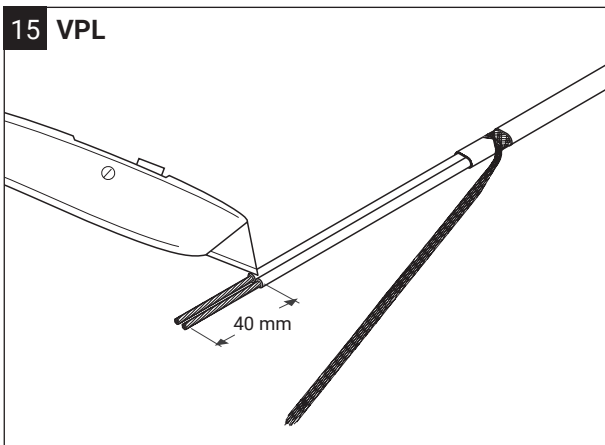

16 BTV, QTVR, XTV, KTV, VPL

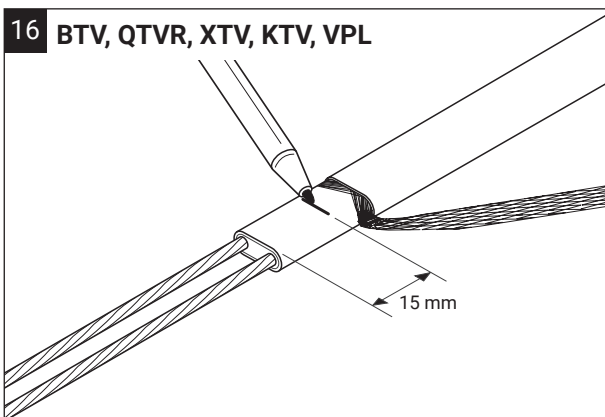

17 BTV, QTVR, XTV, KTV, VPL

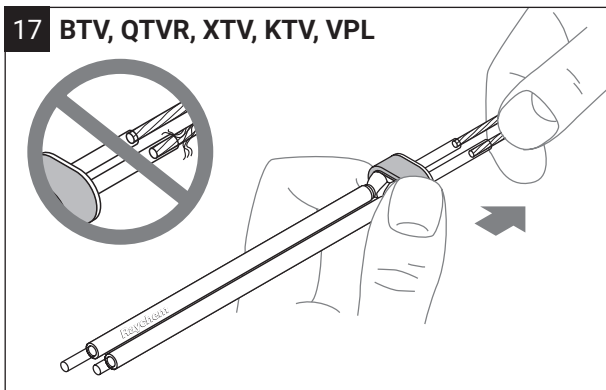

18 BTV, QTVR, XTV, KTV, VPL

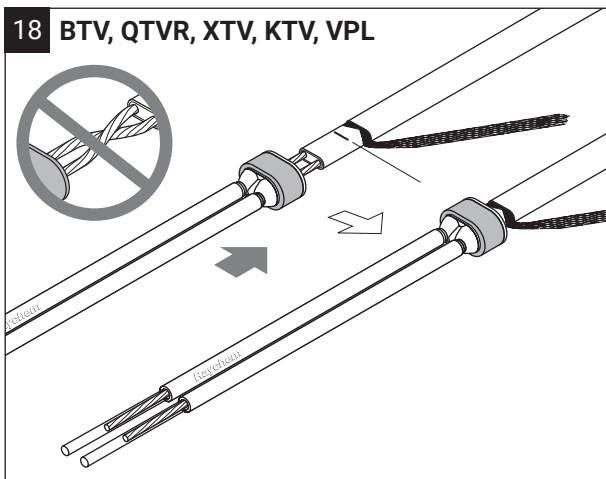

19 BTV, QTVR, XTV, KTV, VPL

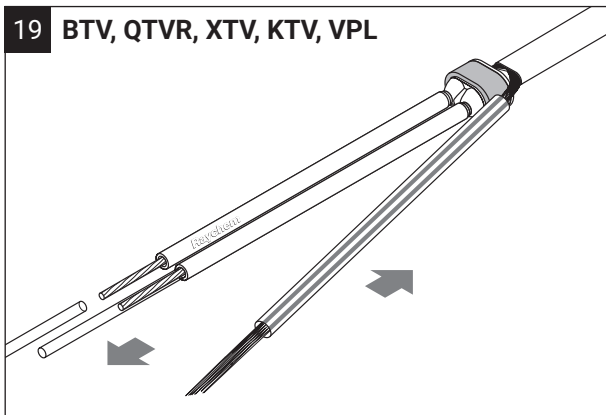

20 BTV, QTVR, XTV, KTV, VPL

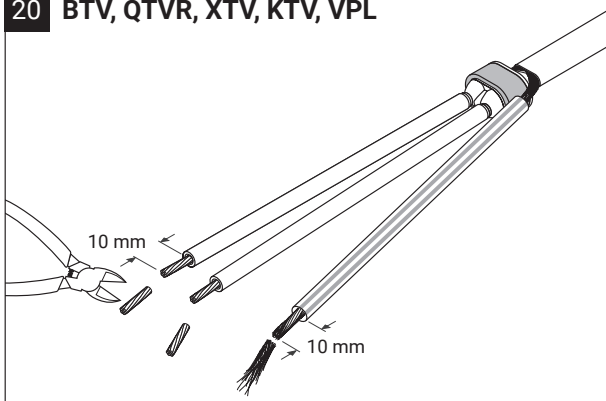

21

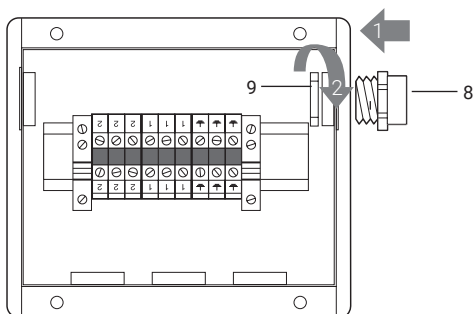

Mount the junction box (types HT-01; HT-02; A-101010 and A-151010 , HT-10, HT-20, HT-30, HT-40 and HT-60. Insert gland (8) into junction box and tighten locknut (9) inside box.

22

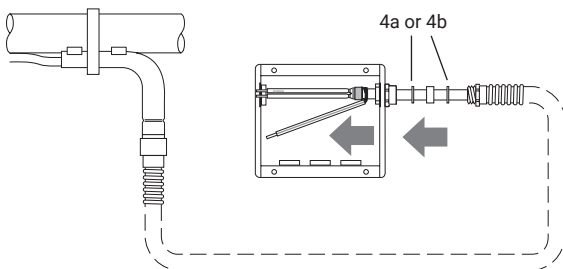

Feed washer (4a or 4b) onto heating cable. Feed heating cable into junction box.

23

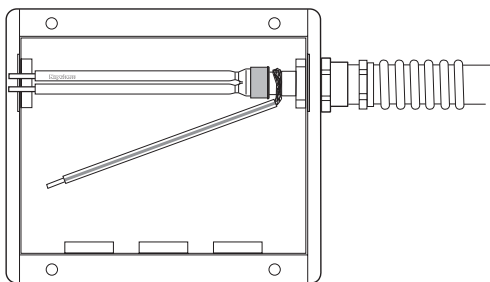

Push grommet into gland body. Tighten conduit adaptor into gland body to compress grommet. Tighten conduit adaptor with hand-force until resistance. Use a spanner and make one last turn.

24

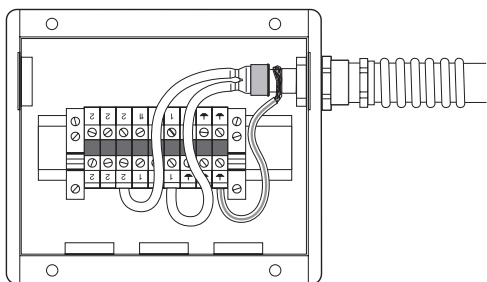

Connect conductors and braid to the appropriate terminals. All unused holes must be sealed with adequate stopping plugs. Replace box lid.

Norway

Tel +47 66 81 79 90

salesno@nvent.com



[nVent.com](https://www.nvent.com)

©2018 nVent. All nVent marks and logos are owned or licensed by nVent Services GmbH or its affiliates. All other trademarks are the property of their respective owners. nVent reserves the right to change specifications without notice.

Raychem-IM-INSTALL136-OSC25100W-EN-1805