

# nVent CADDY New Products



1

## BSZ-SU CONCRETE SCREW

BSZSU08070ZL (402610)

### FEATURES

- European Technical Approval (ETA) for anchoring in cracked and non-cracked concrete
- Approved for use in seismic design category C1
- Removable anchor is ideal for temporary fixings

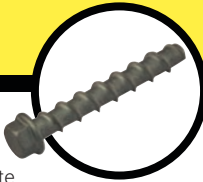

2

## BSZ-M CONCRETE SCREW

BSZM6X35EG (402690)

### FEATURES

- ETA approved for anchoring in cracked and non-cracked concrete
- Ideal for use in concrete with threaded rod

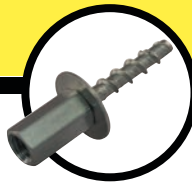

3

## TELESCOPING STRUT REPLACEMENT

TSR3050M10 (366592)

### FEATURES

- Captive threaded nuts enable fastening to threaded rod supports without loose parts
- Telescopes to the desired length and is locked in place by snapping closed a spring retainer clip
- Standard strut profile runs the entire length of the part, allowing most standard fittings to be placed anywhere between the rods
- Integrated ruler displays space between hanger rods in inches and centimeters
- Supports up to seven DN50 conduits, six DN50 water filled pipes at 3 m spacing, or up to 450 mm cable tray
- Conduit can be supported on the top and bottom, eliminating the need for double-sided strut
- Conduit and pipe can be placed directly on the strut profile, saving vertical space in buildings with limited room for installation

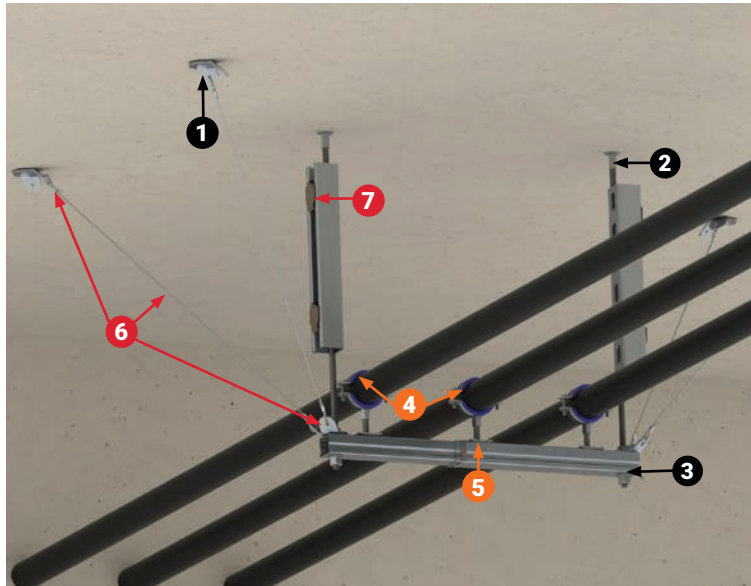

4

## MACROFIX INSULATED M8/M10

MFD050 (586007)

### FEATURES

- Return-lip on the hanger prevents the rubber from detaching, eliminating rework during installation
- Plastic washer prevents screws from falling out during installation
- Combo head bolt works with slotted, hex, or Phillips drivers
- Longer ears position the screw farther from the hanger, improving tool clearance when the screw is driven down
- Combination nut can be attached to M8 or M10 threaded rod, simplifying material handling
- Screw length has been optimized to accommodate an increased pipe range, reducing inventory
- Category II noise reduction according to DIN EN ISO 3822-1
- Compliant for sound insulation design according to DIN 4109
- Reaction-to-fire classification is "E" in compliance with DIN EN 13501-1:2010-01



5

## QUICK STRUT NUT WITH STUD

QSNM10040EG (592922)

### FEATURES

- Provides fast universal attachment of threaded rod and hardware to standard strut profiles
- Pre-assembled slide nut ready to use out of the box
- Spring retains assembly in place until hardware is tightened



6

## CABLE BRACING SYSTEM

### FEATURES

- Ideal alternative to rigid bracing for fire sprinkler systems when brace lengths greater than 6 m are required or where confined/crowded spaces make rigid systems difficult to install
- Includes pre-stretched steel cable, attachment fittings, crimping sleeves and related tools
- Also may be used to brace electrical, mechanical and plumbing systems



7

## QUICK CLIP ROD STIFFENER

CSBRS2 (404538)

### FEATURES

- Secures strut channel to threaded rod for stiffening
- One-hand, snap-in place installation
- No tools or bolt tightening required



### LEGEND

— Electrical/Mechanical — Mechanical — Seismic